

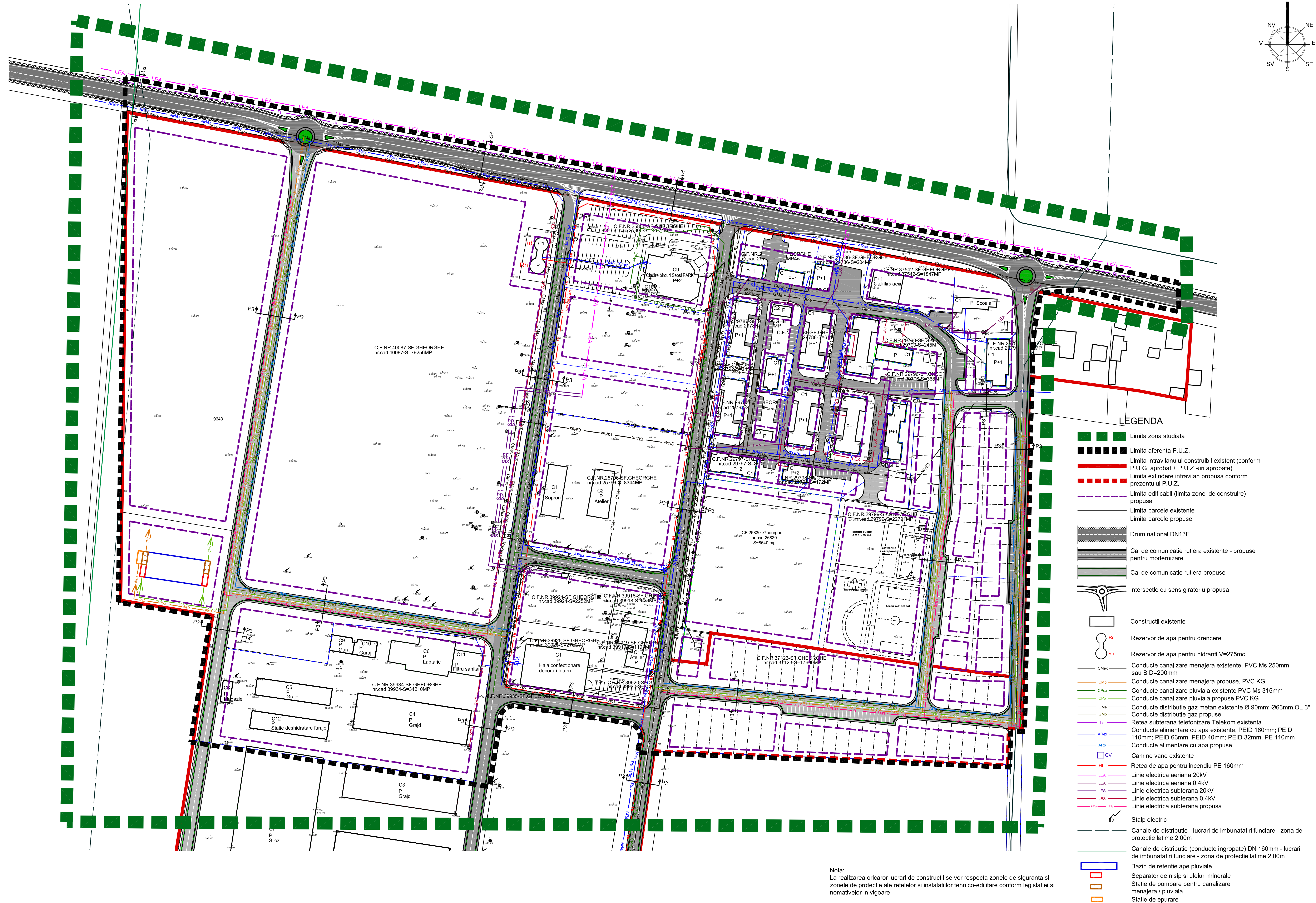

## Retele tehnico-edilitare

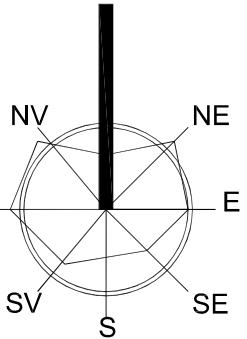

Nota:  
La realizarea oricaror lucrari de constructii se vor respecta zonele de siguranta si zonele de protectie ale retelelor si instalatiilor tehnico-edilitare conform legislatiei si normativelor in vigoare

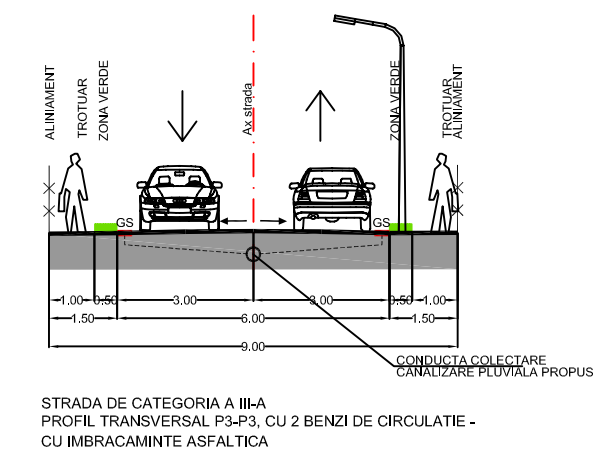
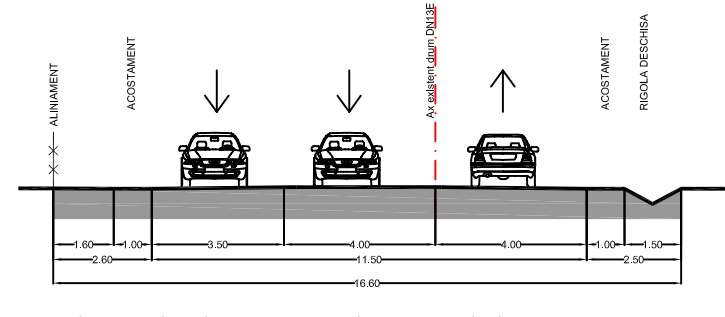
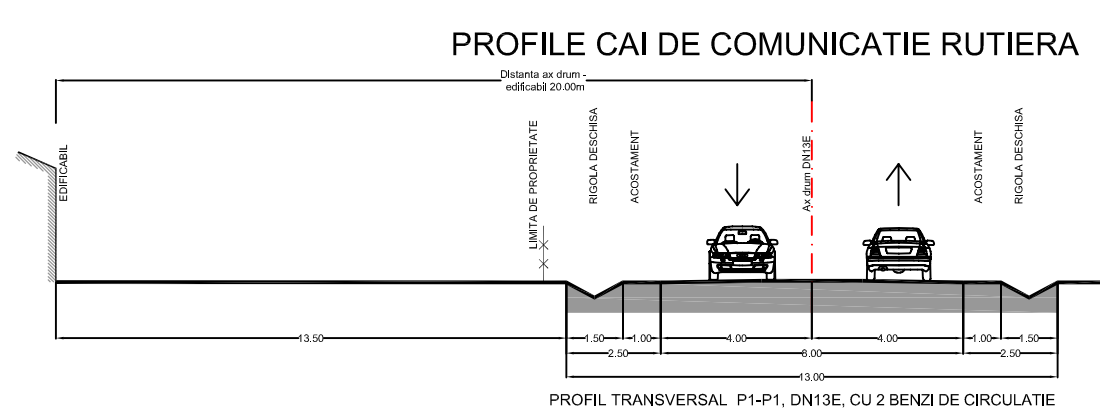

			BENEFICIAR:			PROECT NR.:	
ROMANO-GERMANA DE PROIECTARE SI PRODUCTIE "V&K" S.R.L.			PRIMARIA MUNICIPIULUI SFANTU GHEORGHE			1528/2018	
520009 SFANTU GHEORGHE, ROMANIA, STR. KOSLOV CIOBAN, SANATOR NR.24, Tel.: +40267552303, +40267400573, Email: v&k@v&k.ro j114/763/1992						FAZA:	
			TITLU PROIECT:			P.U.Z.	
			PLAN URBANISTIC ZONAL PLAN CAMPUL FRUMOS			PLANSA NR.:	
NUME		SEMNATURA	SCALAR: 1:000	ADRESA: DN1.E, Top-M-Campul Frumos, mun. Santu Gheorghe			I-03
DATA:		TITLU PLANSA:					
FECH. 2020		RETELE TEHNICO-EDILITARE - SITUATIA EXISTENTA SI PROPUA					
DESINAT		ARH. MONICA RACOVITA					
DREPTURILE DE AUTOR APARTIN S.C.V&K'S.R.L.-ROMANIA, DOCUMENTATIA NU POATE FI COPIATA, REPRODUSA, FARA ACORDUL "V&K" PROTEJAT PRIN "MARCA INREGISTRATA"							